



Commercial Road, E1 1LF
£1,900 PCM

coopers
OF LONDON EST. 1986

Commercial Road, E1

- **AVAILABLE EARLY APRIL 2026**
- **Double Sized Bedroom**
- **Residents Gymnasium & Spa**
- **Key Phone Entry**
- **Gated Secure Development**
- **Concierge Service**
- **Close to Transport Links**

Spacious one double bedroom apartment in a highly sought-after building.

The flat features a combined reception/dining room and modern fitted kitchen. Included in the rent is access to a high quality gym, sauna, 24 hour concierge service and communal roof terrace.

Ideally located for The City and Aldgate East tube.





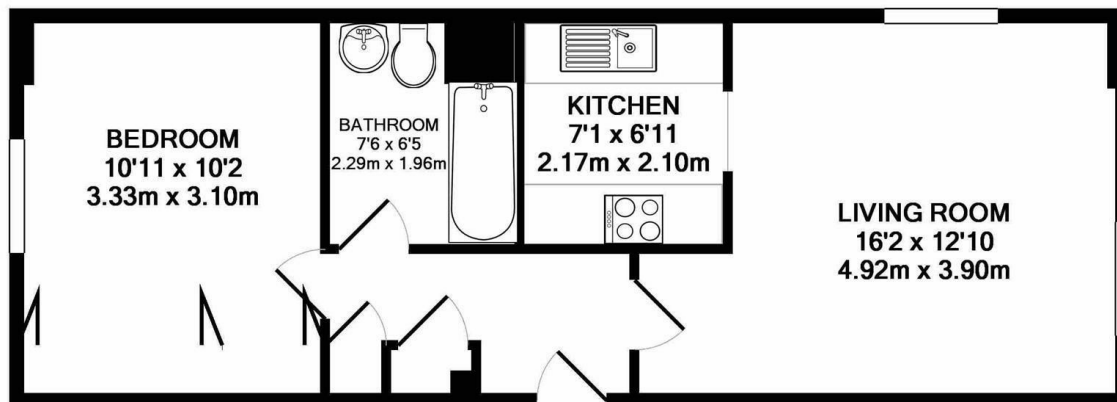

DRYDEN BUILDING, 37 COMMERCIAL ROAD, E1
TOTAL APPROX. FLOOR AREA 454 SQ.FT. (42.1 SQ.M.)



Floorplans are for identification and guideline purposes only, not to scale. Compliant with RICS code of measuring practice. Floor plan supplied by Chik Chak Limited.
Made with Metropix ©2018

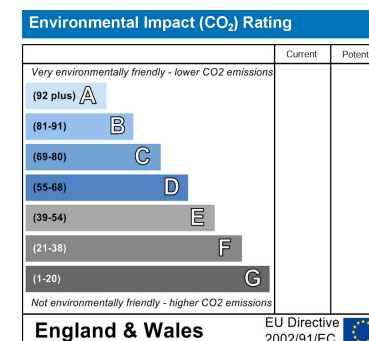
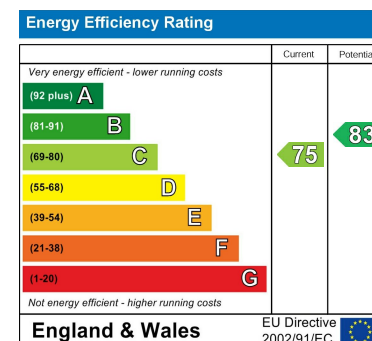

Viewing

Strictly by appointment with:
Coopers of London , 22 Cleveland Street,
Fitzrovia, London W1T 4JB
info@coopersonlondon.co.uk

0207 580 9658

These particulars, whilst believed to be accurate are set out as a general outline only for guidance and do not constitute any part of an offer or contract. Intending purchasers should not rely on them as statements or representation of fact, but must satisfy themselves by inspection or otherwise as to their accuracy. No person in this firms employment has the authority to make or give any representation or warranty in respect of the property.